

99333

Dimensions

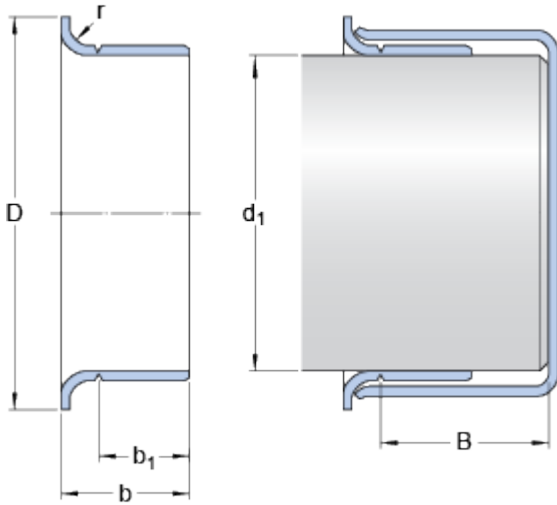

Nominal dimensions

d_1		84.887	mm
D		93.98	mm
Tolerance outside diameter D	\pm	1.6	mm
b		24.994	mm
Tolerance width b	\pm	0.8	mm
b_1		21.006	mm
Tolerance width b_1	\pm	0.8	mm
B	max.	35.001	mm
r	max.	3.18	mm

Shaft diameter range

d_1	min.	84.76	mm
d_1	max.	84.938	mm